

Double Check Valve

Model ED202 – Female BSPP - Datasheet

Description

Double Check Valve with female BSP connections. The ductile iron body is epoxy coated and suitable for wholesome water.

A stainless steel spring closing mechanism allows the valve to operate in any orientation and is immune to water hammer. Water tight closure is achieved at high as well as low pressure by an EPDM seal.

Pipe Connections

Female – DN65, 80 & 100 (2½", 3" & 4") with female screwed connections.

Specification

Pressure (working) 16 bar maximum
 Opening Pressure 0.1 bar
 Temperature -10° C min. to 100° C max.

Materials

Body Ductile iron – epoxy coated (Blue)
 Springs Stainless steel 316
 Closing System Bronze
 Elastomers EPDM
 Fasteners Stainless steel

Applications

Backflow prevention for fluids in categories 1 – 3 (refer to Schedule 1 of Water Regulations July 1999). Fluid Category 3 includes -

- Water softening – commercial (common salt)
- Whole site protection – where Fluid Category 3 required
- Application deemed category 3 by the water company



Model ED65FP202

Dimensions

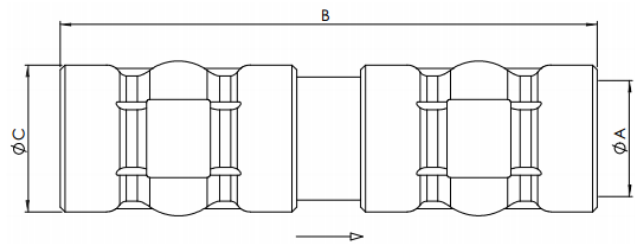

ØA	B	ØC	WEIGHT
"	mm	mm	Kg
2½	65	263	5.9
3	80	312	11.1
4	100	365	17.9

Codes and Descriptions

Size	Code	Description
DN65	ED65FP202	202 Double Check Valve FBSP
DN80	ED80FP202	202 Double Check Valve FBSP
DN100	ED100FP202	202 Double Check Valve FBSP

Head Loss / Flow Chart
 Model ED202

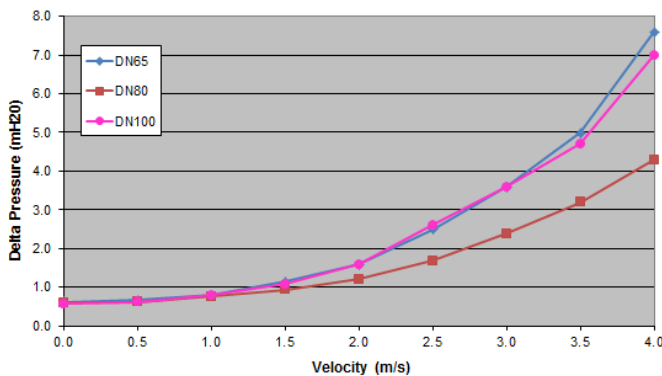

Notes

Other sizes have similar characteristics. Velocity based on flow of water through the bore of copper tube table X. See Flow Table to find the actual flow rate.

Water Regulations

Double Check Valves are suitable for backflow protection of Fluid Category 3 risks as defined in the latest Water Regulations – July 1999.

Test points across a double check valve (ED device) are not required by the new Water Regulations.

Double Check Valves must not be buried. However they can be installed in a chamber below ground. The Water Regulations generally require "Point of Use" protection but whole site and zone are also recognised. The local water company can advise.

Arrow Valves Ltd

Tel: 01442 823123

Fax: 01442 823234

www.arrowvalves.co.uk

Arrow Valves Ltd reserve the right to change specifications, design and materials at any time without notice.

All unit-less dimensions in mm.

© Copyright Arrow Valves Ltd 2001-2019

