



**Installation Instructions /  
Operating & Maintenance Manual  
“Conceal-A-Tap®”  
Model HUC**



**FOREWORD**

The “Conceal-A-Tap®” is a vandal and frost resistant hose union tap by recessing into the wall. A special key is supplied to extend the telescopic assembly and the same key operates the tap.

The hose usually hangs down to avoid kinking; however the telescopic assembly also rotates to enable the hose to exit in any direction.

**SUPPORTING LITERATURE**

HUC Datasheet

SECTION	ITEM
1.0	INSTALLATION
2.0	OPERATION
3.0	MAINTENANCE
4.0	DISASSEMBLING
5.0	CLEANING & LUBRICATING
6.0	REASSEMBLY
7.0	SPARES

## Operating & Maintenance Manual – Conceal-A-Tap – Arrow Valves

### 1.0 INSTALLATION

- 1.1. For cavity walls, it is recommended to use a pilot drill (e.g. 15 mm diameter if this is smaller than core drill pilot) be made through both walls.
- 1.2. Using a 100 mm core drill bore through the external wall only, picking up the pilot hole.
- 1.3. For permanently heated buildings it is acceptable not to insulate the 15 mm copper tube as it passes through the internal wall. In this case bore a hole slightly larger than the 15 mm tube – picking up the pilot. Where insulation is required, bore a hole 30 -35 mm diameter through the internal wall. (A cleaner hole is normally achieved if drilling from the inside).
- 1.4. Insert the tap assembly into the large hole. If it is loose, it is recommended packing is added to the circumference of the housing such as tape, aluminium foil etc, so the housing is a snug fit. Using the housing as a template, drill the three holes in the wall. The diameter should be suitable for wall plugs and No.6 screws. Note - to avoid the holes breaking into larger holes, it is desirable to bias the drill outwards by 10 degrees, away from the large main hole.
- 1.5. Remove housing, fit wall plugs, refit housing and secure with the three screws.
- 1.6. Fit the stainless steel disc (2) with the two screws (3) using the 4 mm hexagon key provided.
- 1.7. Connect the inlet to the supply. Normally an elbow is used inside the building. Use push-fit or compress – not solder.
- 1.8. Flush pipes.
- 1.9. Connect via a full bore servicing valve and a low head loss Double Check Valve (assuming the application is not Fluid Category 4 or 5 – contact Arrow Valves for advice). A full bore servicing valve and low head loss Double Check Valve (BVED15C515) is supplied in the installation kit.

### 2.0 OPERATION

- 2.1. The Stainless Steel Disc (2) is normally pushed in when not in use.  
**Turning On**
- 2.2. Partially insert Special Key (22) through central hole in the Disc (2), turn Key ¼ turn so Key cross pin is horizontal.
- 2.3. Pull Disc (2) out to limit.
- 2.4. Connect hose with brass “Inter-Lock” (21 – supplied in installation kit) or plastic “Hozelock” connector. Note – brass type requires the release ring to be pulled back when pushing connector in.
- 2.5. Push Key in fully, turn tap on (counter clockwise).  
**Turning Off**
- 2.6. Insert Key (22) and turn valve off (clockwise).
- 2.7. Disconnect Hose Connector (21) by pulling back release ring on.
- 2.8. Push Disc (2) into the wall).

### 3.0 MAINTENANCE

- 3.1. If the water quality is poor – e.g. high calcium carbonate content, the telescopic assembly may become stiff. Cleaning and lubricating the bore should restore the free action.

### 4.0 DISASSEMBLING

- 4.1. Isolate water supply at servicing valve.
- 4.2. Insert Key, pull Disc (2) out and open valve to relieve pressure. Remove Key.
- 4.3. Remove the two button head screws (3) and remove Disc (2).
- 4.4. Push the Piston (4) back into the Housing.
- 4.5. Remove the three screws (7).
- 4.6. Pull the Piston (4), the assembly should withdraw from the Housing.
- 4.7. As applicable, remove the Cartridge (13) using a socket or box spanner.
- 4.8. Insert a long series 3 mm hexagon Key into the centre of the Piston (4), through the hollow Screw (10) and locate into Screw (12). Unscrew.

### 5.0 CLEANING & LUBRICATING

- 5.1. If the bore has scale deposits, remove with a de-scaling acid – using gloves and protective equipment.
- 5.2. Clean the Piston (4) and replace seals as necessary.

## Operating & Maintenance Manual – Conceal-A-Tap – Arrow Valves

5.3. Lubricate the bore and Tube bore (5) with silicone grease.

### 6.0 REASSEMBLY

- 6.1. As applicable, replace the Cartridge (13). Tighten with a box spanner or socket.
- 6.2. Fit the Spindle Extension (11), tighten Screw (12) using a 3 mm hexagon key.
- 6.3. Replace the O-ring (9).
- 6.4. Smear a little silicone grease inside the Tube (5).
- 6.5. Insert the Piston (4) into the Housing, ensuring the O-ring enters the Tube (5)
- 6.6. Align the Backstop (6) and replace the three screws (7).
- 6.7. Refit the Disc (2) using the two screws (3).
- 6.8. Insert the Key (22), turn Key so cross pin is horizontal; pull Disc (2) out to stop.
- 6.9. Insert the Key (22) and turn valve off.
- 6.10. Open Servicing valve.
- 6.11. Test, ensuring Piston (4) is fully extended before opening valve.

### 7.0 SPARES

- 7.1. Please contact Arrow Valves for any spares required on 01442 823123 or online at [www.arrowvalves.co.uk](http://www.arrowvalves.co.uk).

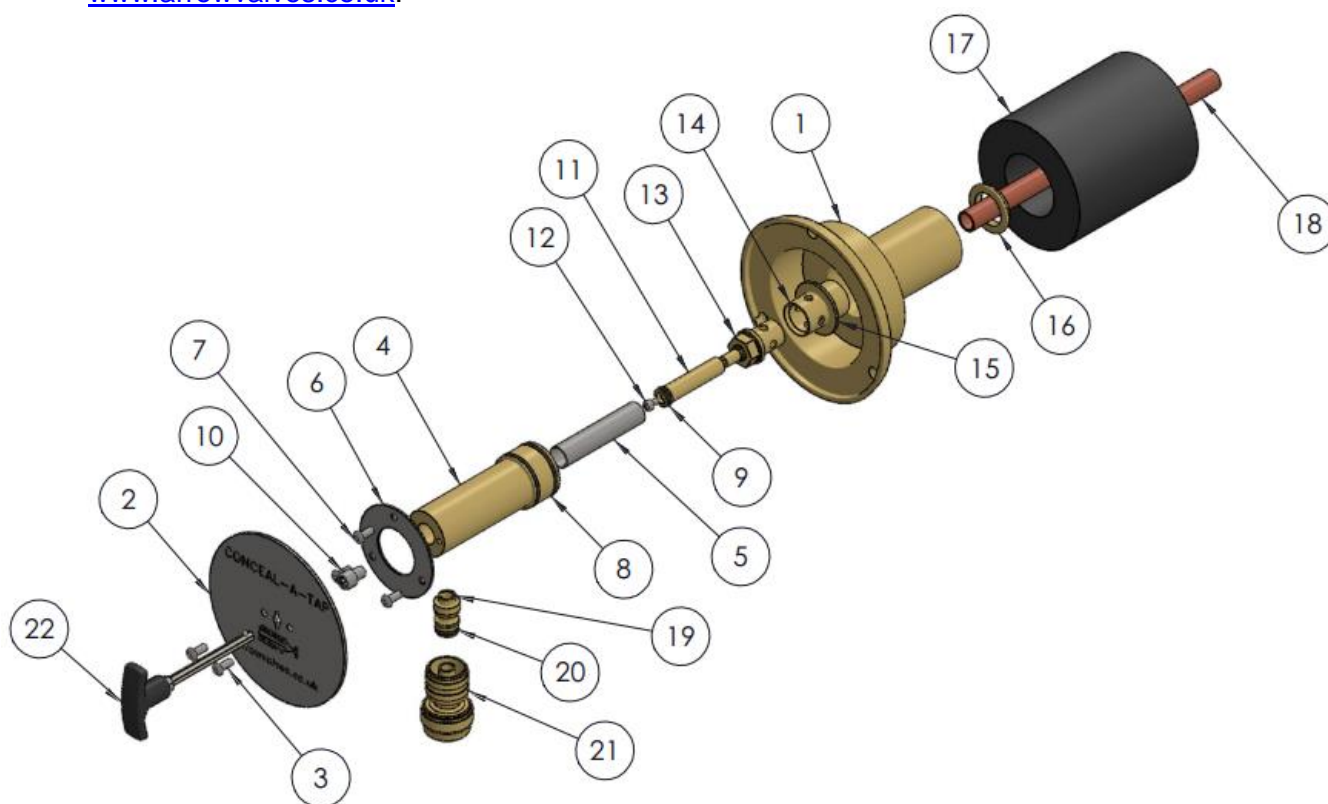

ITEM NO.	DESCRIPTION	QTY.	ITEM NO.	DESCRIPTION	QTY.
1	HOUSING	1	12	SOCKET SCREW	1
2	DISC	1	13	CARTRIDGE	1
3	M5x10 SCREW	2	14	CARTRIDGE TAIL	1
4	PISTON	1	15	CART. TAIL O-RING	1
5	TUBE	1	16	FLANGED BACKNUT	1
6	BACKSTOP	1	17	INSULATION	1
7	M5x10 SCREW	3	18	COPPER TUBE	1
8	PISTON O-RING	2	19	HOSE PLUG	1
9	SPNDLE EXT. O-RING	1	20	HOSE PLUG O-RING	1
10	TAPPED SCREW	1	21	HOSE CONNECTOR	1
11	SPINDLE EXTENSION	1	22	KEY	1